

Flush Mounting

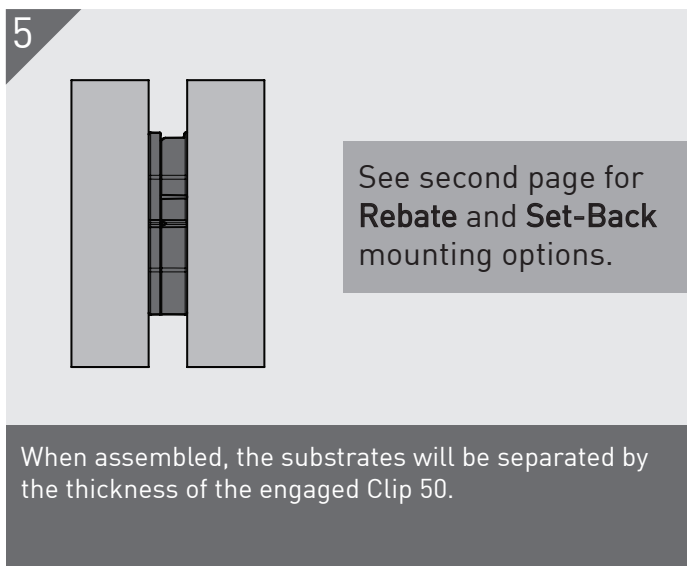

Rebate Mounting

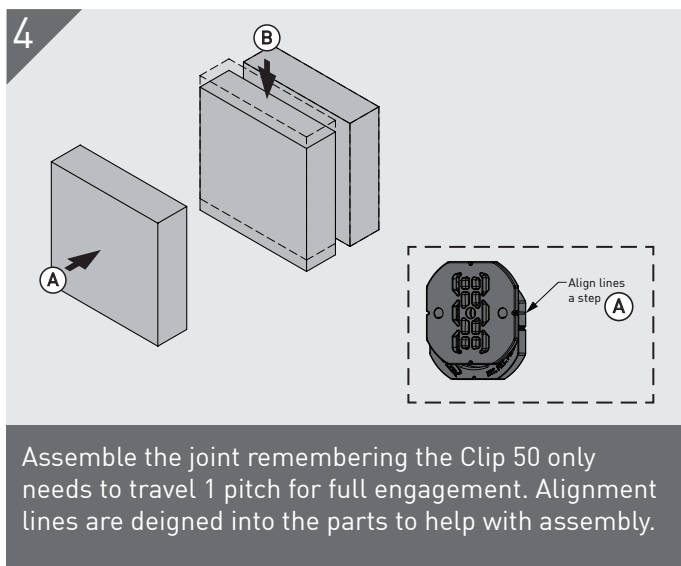
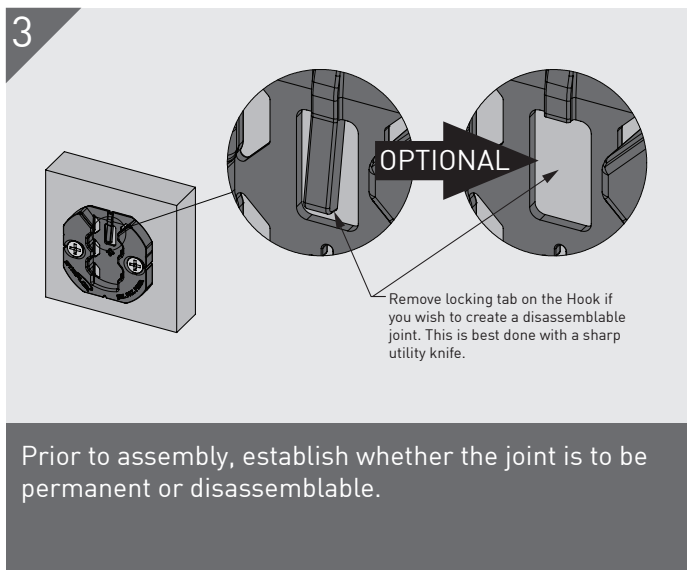
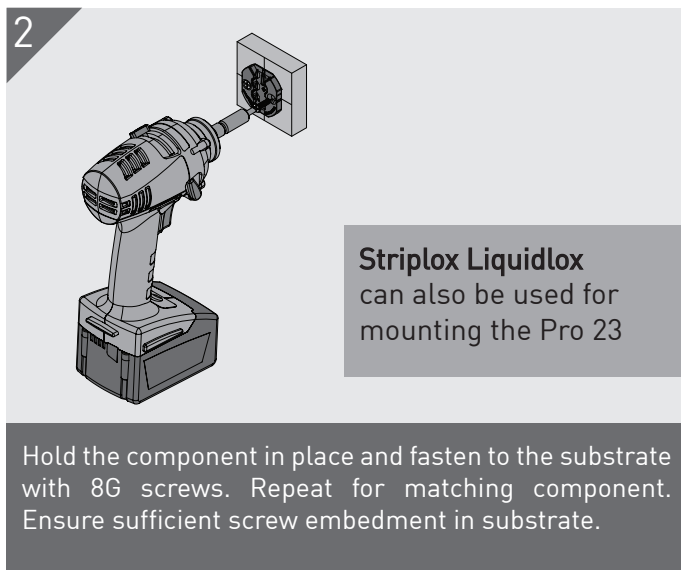
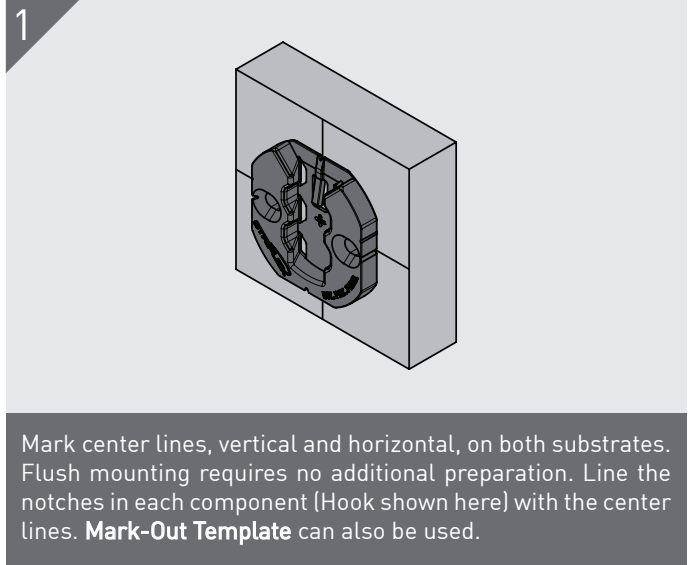
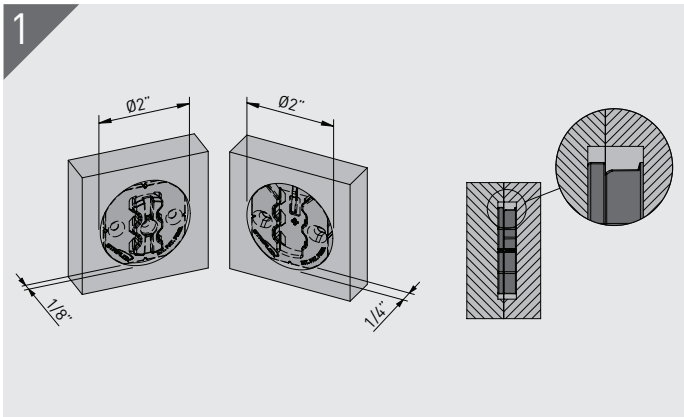

Part Rebate - each substrate mounting face is rebating as shown. Ensure sufficient screw embedment in substrate.

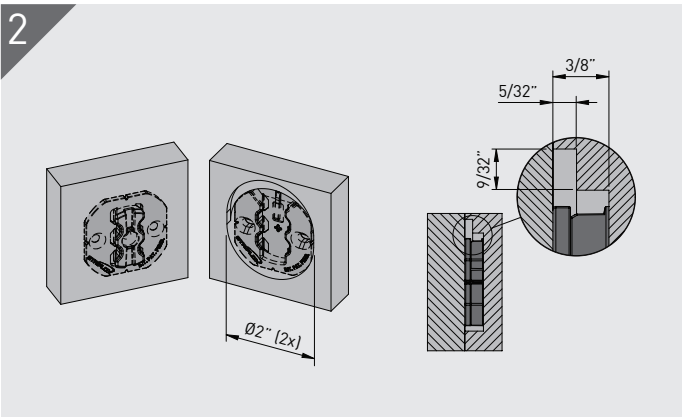

Full Rebate - 1 of the substrate mounting faces is rebating the full depth as shown. Ensure sufficient screw embedment in substrate.

Set-Back Mounting

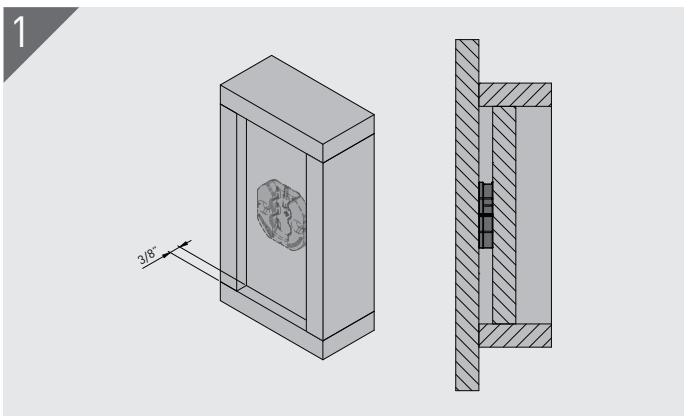

Setting back the mounting face of either the Hook (as shown) or Key by 9.5mm results in a concealed joint without the need to cut rebates.

Installation Aids

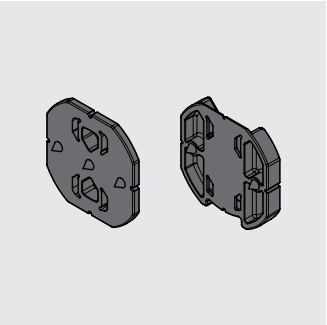

Striplox Clip 50 Jig
Designed to be used in conjunction with either the Clip 50 Key or Hook to mark screw locations in a wide variety of substrates.

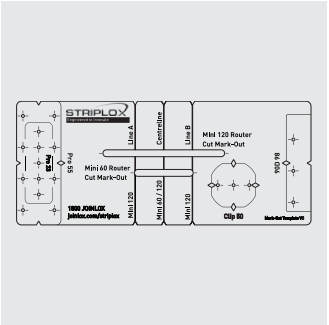

Striplox Mark-Out Template
Developed to aid in the installation of the Striplox Pro 23, Pro 55, 90D 98, Clip 50, Mini 60 and 120.

Load Capacity

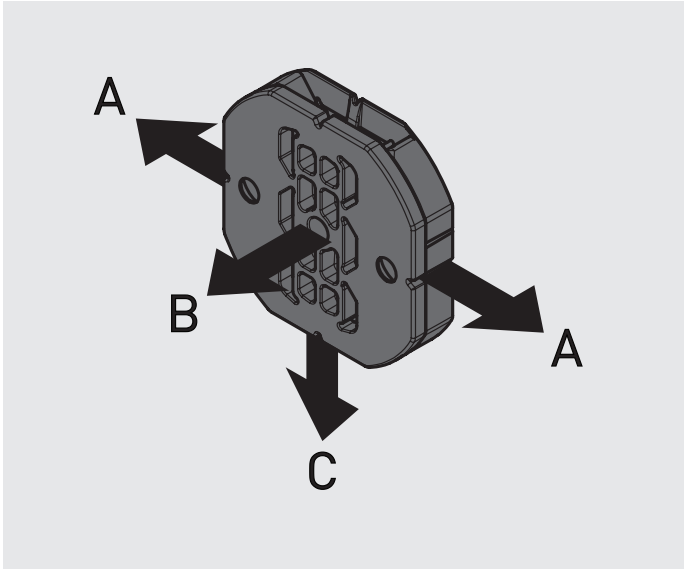

Direction	Indic. Load Capacity
A	209 lb
B	209 lb
C	275 lb

- Tested using particle board and fixed with screws.
- Ensure sufficient screw embedment in substrate.