

EDGE BANDING

INSTALLATION INSTRUCTIONS

1. Panels should be square and relatively smooth. Remove all sawdust from the edge. Cut Outwater's Veneer Edging slightly longer than the panel side to be edged.
2. **(FIGURE 1)** Hold Outwater's Veneer Edging onto the edge using your thumb and forefinger as a guide. Press into the proper position.
3. **(FIGURE 2)** With a home electric iron set at 400°F or 200°C (cotton setting) iron Outwater's Veneer Edging to the panel edge. Move the iron slowly allowing heat to penetrate the wood and activate the adhesive. Follow ironing immediately with pressure by moving a block of wood along Outwater's Veneer Edging and pressing Outwater's Veneer Edging firmly down onto edge.
4. **(FIGURE 3) Trim the Edges:** When Outwater's Veneer Edging has cooled off, you can flush trim the top and bottom edges with a sharp utility knife and a block of wood.
NOTE: A flush trimming tool makes the trimming process easier.
5. **(FIGURE 4) Cutting Off the Edges:** To remove the overhanging ends, simply slice them off with a utility knife. Place Outwater's Veneer Edging on a surface and score it a couple of times.
6. **(FIGURE 5)** After trimming all the edges, hold the sanding block with 150-grit sandpaper at a slight angle and smooth out the edges.
7. Stain or finish Outwater's Veneer Edging to desired color or match to the panel.

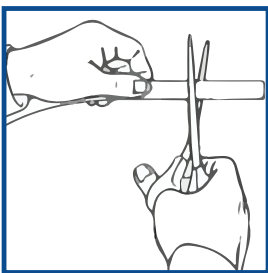

FIGURE 1

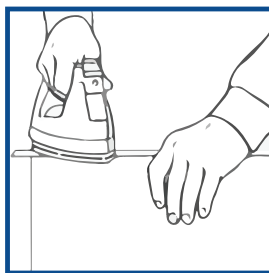

FIGURE 2

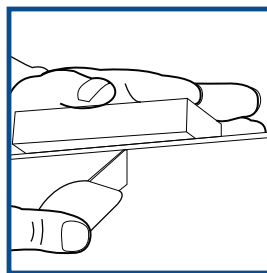

FIGURE 3

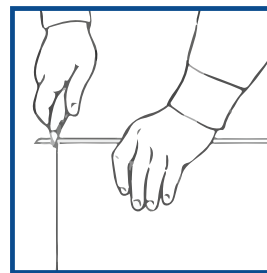

FIGURE 4

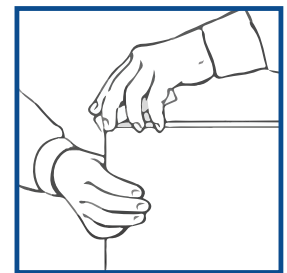

FIGURE 5