

## SQUARE ALUMINUM COLUMNS ASSEMBLY

Square column sections snap together. This should be done on a solid surface such as the floor or a table. The easiest method is to tilt all of the joints into place and snap the last one together. It is best to use a rubber mallet for this. If you use a steel hammer, be sure and use a block of wood on the columns to prevent the hammer from marking the metal.

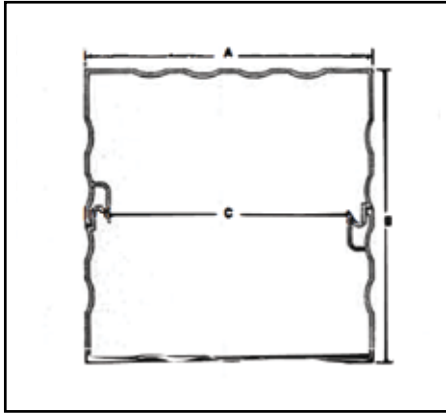

4" and 6" columns have two sections each.

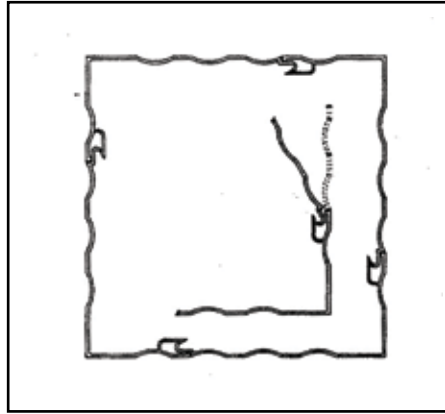

8", 10" and 12" columns have four sections each.

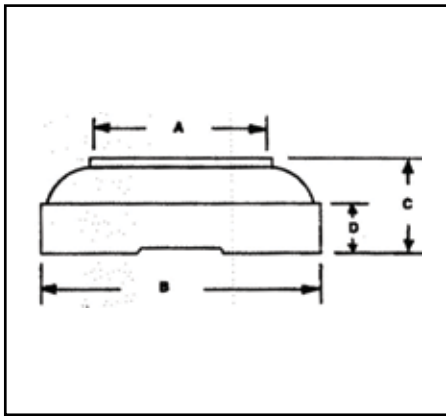

Standard: Cast Aluminum  
Standard Cap and Base

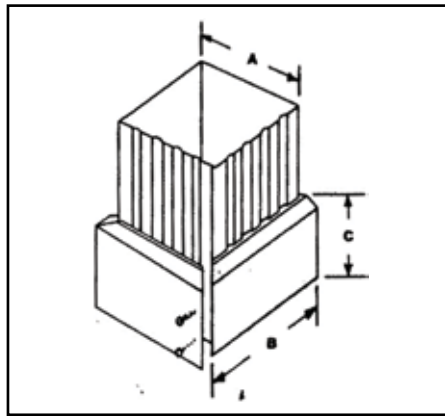

Original: Wrap-around  
Cap and Base

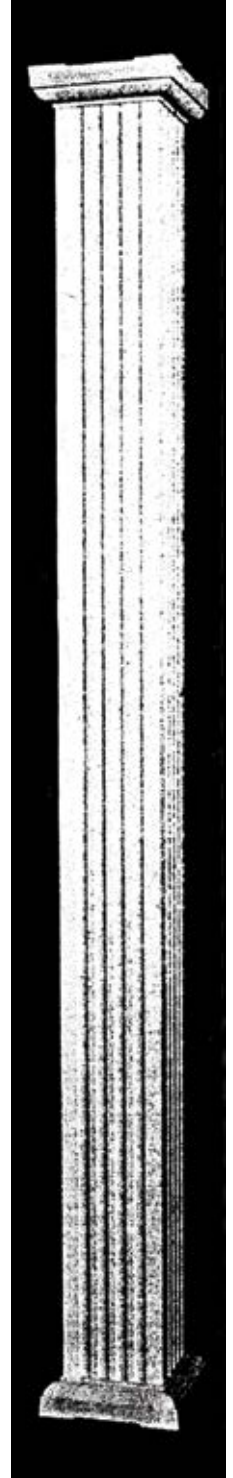

**SQUARE COLUMN**

| Square Column Dimensions |                 |           |           |           |
|--------------------------|-----------------|-----------|-----------|-----------|
| Column Size              | No. of Sections | A         | B         | C         |
| 4"                       | 2               | 4 - 1/4"  | 4 - 1/4"  | 3 - 3/8"  |
| 6"                       | 2               | 5 - 1/2"  | 5 - 1/2"  | 4 - 5/8"  |
| 8"                       | 4               | 7 - 1/2"  | 7 - 1/2"  | 6 - 5/8"  |
| 10"                      | 4               | 9 - 3/8"  | 9 - 3/8"  | 8 - 1/2"  |
| 12"                      | 4               | 11 - 1/2" | 11 - 1/2" | 10 - 1/2" |

| Cap and Base Dimensions |           |           |          |          |
|-------------------------|-----------|-----------|----------|----------|
| Column Size             | A         | B         | C        | D        |
| 4"                      | 4 - 1/4"  | 6 - 1/2"  | 1 - 7/8" | 1"       |
| 6"                      | 5 - 1/2"  | 8 - 1/2"  | 2 - 3/4" | 1 - 1/2" |
| 8"                      | 7 - 1/2"  | 10 - 1/2" | 2 - 3/4" | 1 - 1/2" |
| 10"                     | 9 - 3/4"  | 12 - 1/4" | 3"       | 1 - 5/8" |
| 12"                     | 11 - 7/8" | 14 - 5/8" | 3 - 1/4" | 1 - 3/4" |

| Standard Stock Sizes |               |           |               |           |               |
|----------------------|---------------|-----------|---------------|-----------|---------------|
| Size                 | Wt. in Pounds | Size      | Wt. in Pounds | Size      | Wt. in Pounds |
| 4" x 8'              | 15 - 1/4      | 10" x 10' | 48 - 1/2      | 12" x 12' | 78            |
| 6" x 8'              | 20            | 10" x 12' | 57 - 1/4      | 12" x 14' | 90            |
| 6" x 9'              | 22            | 10" x 14' | 66            | 12" x 16' | 102           |
| 6" x 10'             | 24            | 10" x 16' | 74 - 3/4      | 12" x 18' | 114           |
| 8" x 8'              | 28            | 10" x 18' | 83 - 1/2      | 12" x 20' | 126           |
| 8" x 9'              | 31            | 10" x 20' | 92 - 1/4      |           |               |
| 8" x 10'             | 34            |           |               | 12" x 24' | 150           |
| 8" x 12'             | 40            |           |               |           |               |

| Compression Load Test Results |                 |                |
|-------------------------------|-----------------|----------------|
| Column Size                   | No. of Sections | Load in Pounds |
| 4"                            | 2               | 11,000         |
| 6"                            | 2               | 12,000         |
| 8"                            | 4               | 9,000          |
| 10"                           | 4               | 17,000         |
| 12"                           | 4               | 17,000         |