



Striplox™ Mini 120

Concealed joints made easy

Striplox Mini connector systems offers flexible and swift handling as well as rapid assembly, producing concealed permanent and reusable invisible joints. Striplox Mini utilises the internationally patented, award winning joining solutions.

Integrating Striplox into your products and processes uses existing methods, but delivers fast, strong assembly of components, panels or sections – either in the factory, in the home or even in the most remote site locations.

Modular components can be shipped in flat pack form for a fraction of the cost, delivering significant competitive advantages. The Striplox Mini provides a secure fully concealed joint suitable for numerous applications offering strength, durability and versatility with limited tools, no loose fasteners and saves on skilled labour costs.



Benefits

- No visible fixings – completely concealed joint
- Eliminates damage – install panels during final build
- Lower transportation cost – flat pack
- Lower labour costs with fast on site assembly
- Strength, Durability and Versatility
- Cabinetry or panels can be fitted permanently or removed with ease
- Joining will not interfere with substrate finish ie. Veneers, 2pac paint
- Can be used in substrates of 1/2in thickness and upwards

Applications

- Feature ceilings, walls, cabinetry, shelving
- Commercial wall paneling and office partitioning
- Modular entertainment builds
- Locker systems assemblies
- Toilet/shower partitioning
- Wardrobe fit outs
- Framing of artwork/mirrors
- Furniture construction and interior fitting
- Shop fitting displays and signage
- Exhibition and trade events
- DIY garden shed and Patio
- RV and Marine fit outs



How it works

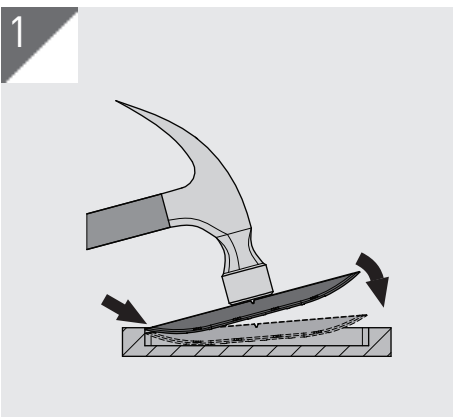

Installation

Apply glue to the groove. To aid in the installation, start by inserting one end in the slot then use a hammer or mallet to tap the Striplox Mini into place.

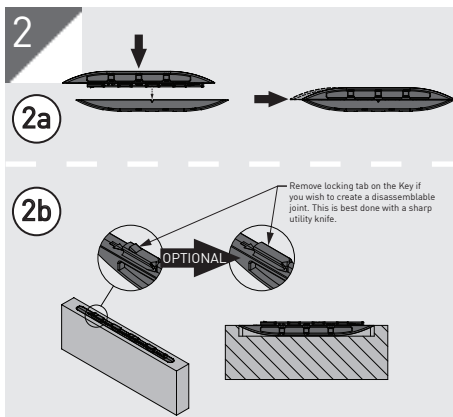

Assembly

Before assembling the Striplox Mini 120, make note of the locking tab. Leaving this tab in place will prevent unintentional unlocking of joint.

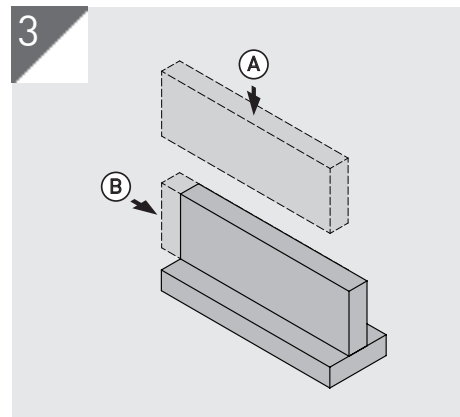

Completion

Due to the unique design, the key only need to travel one pitch for full lock-up, giving you a firm, invisible joint every time.

Specifications

Material: High Strength Reinforced Nylon Colour: Black Fixing: Glue <ul style="list-style-type: none"> Tested using MDF and fixed with glue. *C is in direction of lock-up 	Direction	Indic. Load Capacity
	A	440 lb
	B	322 lb
	*C	262 lb

- Refer to Mounting Data Sheet for full dimensions
- Refer to Installation Guide

Dimensions

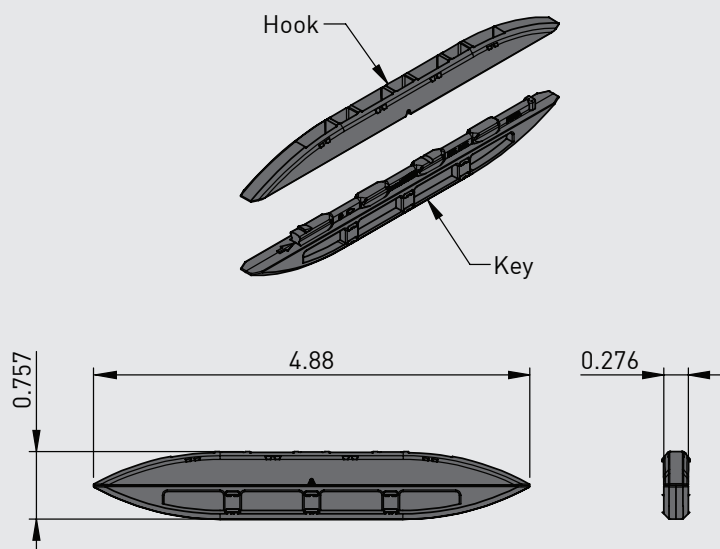

Load Direction

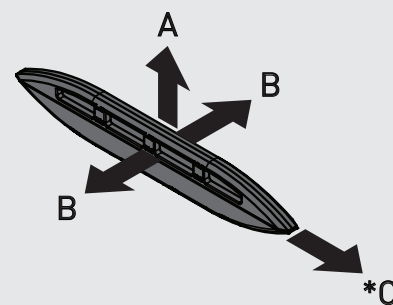

Proudly Australian Designed, Owned and Manufactured

Striplox products are designed and tested for a range of applications. Product use is subject to variable materials and conditions. Technical information and load capacities are a guide only without warranty and Joinlox will not be liable for any subsequent damage or loss from the use of the products or this information.